

DIRECTIONS

1052R Washington Street
Gloucester, MA 01930

The cemetery is 350 feet in from Washington Street. Look for the sign **Lane's Cove Cemetery** on Washington Street marking the walkable lane to the cemetery. No driving or parking is allowed on the lane. Parking is available on Washington Street and municipal transportation is offered: CATA on demand (Mon-Fri) or the regular CATA route to Lanesville.

The cemetery is not handicapped accessible, and the terrain is uneven. "As a participant of the cemetery tour, you agree to waive, release and hold harmless the City of Gloucester from any and all claims, damages, and causes of action arising out of your participation in the cemetery tour given by the City of Gloucester or taken as a self-guided tour."



Care of City-owned Cemeteries

Cove Hill is one of 14 Gloucester city-owned cemeteries. The care and maintenance of these city-owned cemeteries are managed by the Gloucester DPW, the City-owned Cemeteries Advisory Committee and Cemetery Volunteers.

For more information on Gloucester's city-owned cemeteries visit

<https://gloucester-ma.gov/869/Cemeteries-Advisory-Committee>

If you are interested in becoming a Cemetery Volunteer contact us at cemeteriesadvisorycommittee@gmail.com

For additional Cove Hill genealogical information search **Find a Grave**, <https://www.findagrave.com/cemetery/1613187/cove-hill-cemetery>

Tax-deductible donations for the restoration and preservation of Gloucester's city-owned cemeteries are always appreciated. Donations can be sent to :

Gloucester Historic Burial Ground

Att: Rose LoPiccolo, DPW
9 Dale Avenue
Gloucester, MA 01930

COVE HILL CEMETERY



On December 17, 1717, a burying place in the northern part of Cape Ann, known as Flatstone Cove, was approved by the Town of Gloucester selectmen. A half an acre of land overlooking Ipswich Bay was donated by John Lane, therefore establishing **Lane's Cove Cemetery** in 1720.

The cemetery, also known historically as **Harvey's Cemetery** or **Cove Hill**, bears witness to the remains of many of the early settlers of northern Gloucester: the **Duley, Gott, Haraden, Lane, Langsford, Norwood, Sargent, Saunders, Woodbury,** and **Young** families. These early families built prosperous lives through dairy farming and fishing Ipswich Bay.

This small, hidden historical cemetery has been beautifully cared for over 25 years through the stewardship of Joyce and Walter McGrath of Lanesville.

Exploring the Cemetery

The first recorded burial was Deborah, daughter of John and Dorcas Lane, who died May 9, 1729, at age 27. The last recorded burial in 1901 was 48-year-old Rose R. Griffin, the wife of James and mother of Rose A. Griffin. The mother was buried with their only child who died in 1880 at age 5. We invite you to wander among the early settlers and American Revolutionary and Civil War Veterans of Cove Hill and appreciate their contributions and sacrifices that helped shape the City of Gloucester.

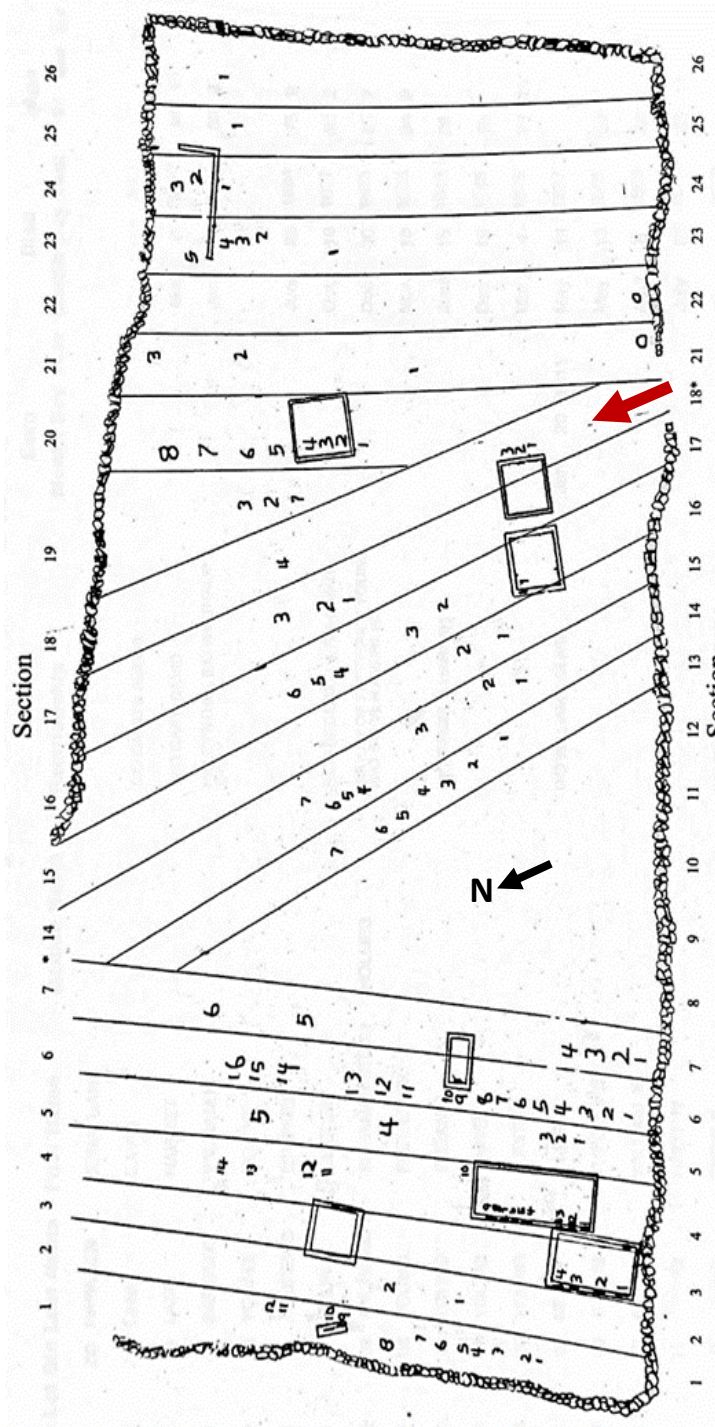

The cemetery map and section information were taken from the **Cove Hill Cemetery Inventory** by Roger Davis (2004). The red arrow marks the entrance to Cove Hill. The numbers in each section mark gravestones.

Cemetery Family Sections

- 1: Andrews, Newman, Young
- 2: Lane, Saunders
- 3: Munsey, Sargent
- 4: Lane, Sargent
- 5: Duley, Lane, Sargent
- 6: Griffin, Haraden, Lane, Langsford, Lowe, Lucas, Peabody, Tucker, Walen
- 7: Haraden, Lane, Young
- 13: Lane
- 14: Lane, Morgan, Tucker, Sargent
- 15: Sargent
- 16: Lane, Sargent, Woodbury
- 17: Langsford
- 18: Griffin, Sargent
- 19: Norwood
- 20: Gott, Knights, Norwood, Parsons, Wheeler
- 21: Blaisdell, Gott, Norwood, Wheeler
- 22: Blaisdell
- 23: Gott, Wheeler, Young
- 24: Young
- 25: Gott
- 26: Unknown



SCAN ME